



LOCAL PLANNING SCHEME NO. 8

**APPLICATION FOR
DEVELOPMENT APPROVAL
MICRO-BREWERY**

The City of Karratha has received an application for development approval DA18146, which proposes a Micro-Brewery to be located at Lot 100 Mooligunn Road, Karratha Industrial Estate WA 6714.

Details of the application are available for inspection during office hours, at the City of Karratha's Administration Office located on Welcome Road, Karratha or on the City's website:

www.karratha.wa.gov.au/public-notifications.

Submissions are welcome and should be made in writing to the City of Karratha, PO Box 219, Karratha WA 6714 or via email to submissions@karratha.wa.gov.au on or before **4:30pm 22nd November 2018**.

**Chris Adams
Chief Executive Officer**

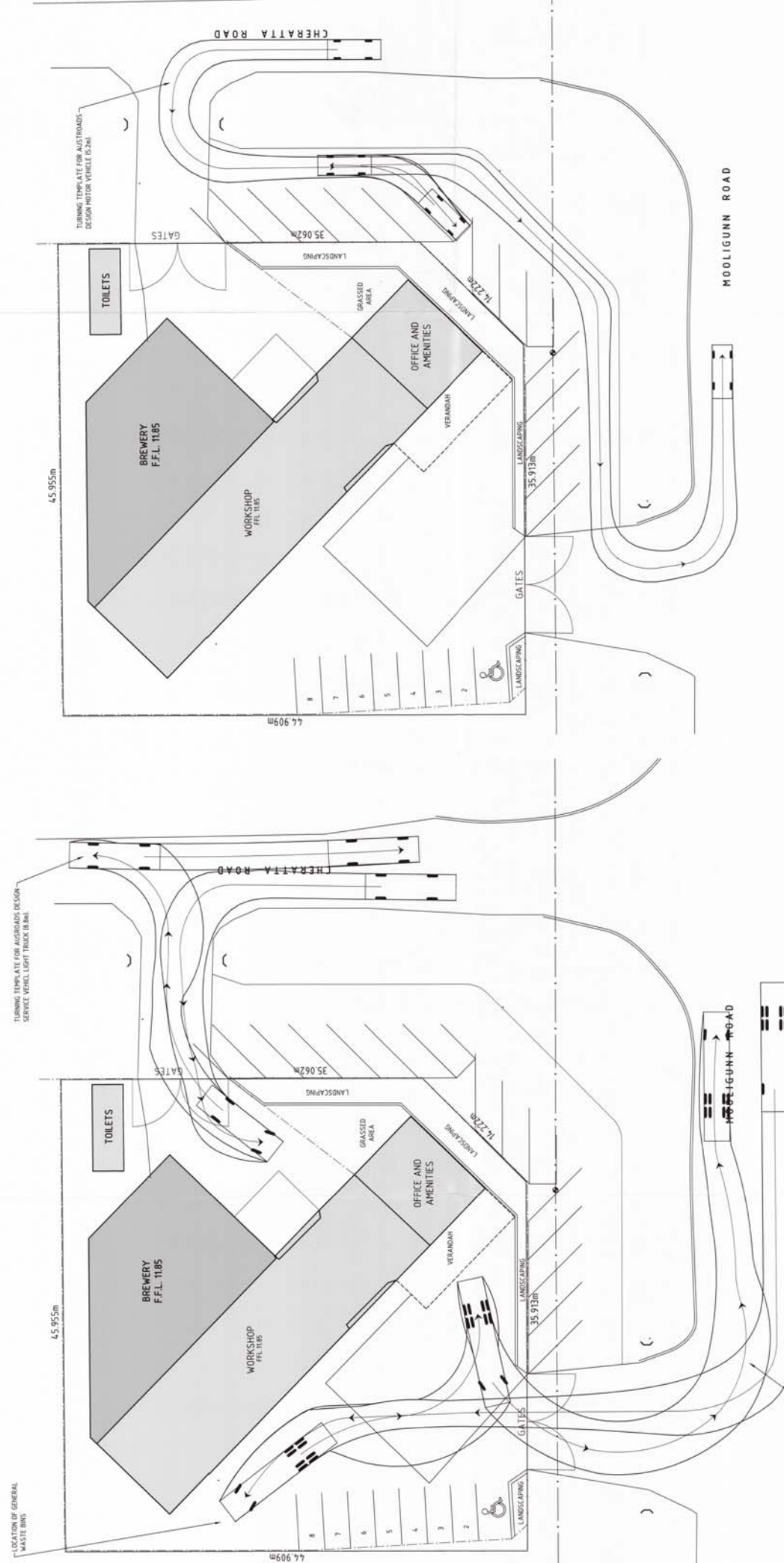

LOCATION OF GENERAL WASTE BINS

TURNING TEMPLATE FOR AUSTRADAYS DESIGN MOTOR VEHICLE 6.5m

TURNING TEMPLATE FOR AUSTRADAYS DESIGN SERVICE VEHICLE LIGHT TRUCK 8.8m

TURNING TEMPLATE FOR AUSTRADAYS DESIGN 5U HEAVY TRUCK 10.5m

TRAFFIC MOVEMENT SITE PLANS
1:100

DESIGN	CLIENT	JUNE 2018	JUNE 2018	JUNE 2018	JUNE 2018
DRAWN	P.K.	—	—	—	—
CHECKED	L.R.	—	—	—	—
ENGINEER	—	—	—	—	—
ISSUED	—	—	—	—	—

REV	BY	DATE	DESCRIPTION
F	PK	17/01/18	INCLUDE VERGE PARKING, RE-ISSUE FOR CDPK PLANNING
E	PK	25/01/18	ISSUE FOR CDPK PLANNING
D	PK	13/01/18	4.500M VERGE PARKING AND RE-ISSUE FOR PLANNING REVIEW
C	PK	21/01/18	DEVELOP DRAWINGS AND RE-ISSUE FOR REVIEW
B	PK	16/01/18	REVISE AND RE-ISSUE FOR REVIEW
A	PK	21/01/18	ISSUE FOR REVIEW

APP	DATE	DESCRIPTION
—	—	—

L.E. ROBERTS BUILDING DESIGN ARCHITECTURAL DESIGN CONSULTANTS		SCALE: 1:200 (A1)
NORTHWEST BREWING PROPOSED CRAFT BREWERY LOT 100 MOOLIGUNN ROAD, KARRATHA LIA		DRAWING NO: 783-04-05 SHEET: 02 OF 05

LEGEND

TASTING AREA/DOOR SALES
 DOOR SALES AND BEER TASTINGS ARE TO BE USED FOR GENERAL PUBLIC
 AND ORGANISED BREWERY TOURS. THIS IS A PRINCIPAL/ANCILLARY USE TO
 BE USED FOR GENERAL PUBLIC AND ORGANISED BREWERY TOURS.
 TOTAL WORKSHOP AREA = 540.34sq2
 DOOR SALES/TASTING AREA = 56.00sq2
 THEREFORE THIS AREA IS LESS THAN 10% OF THE ORIGINAL WORKSHOP
 FLOOR AREA.

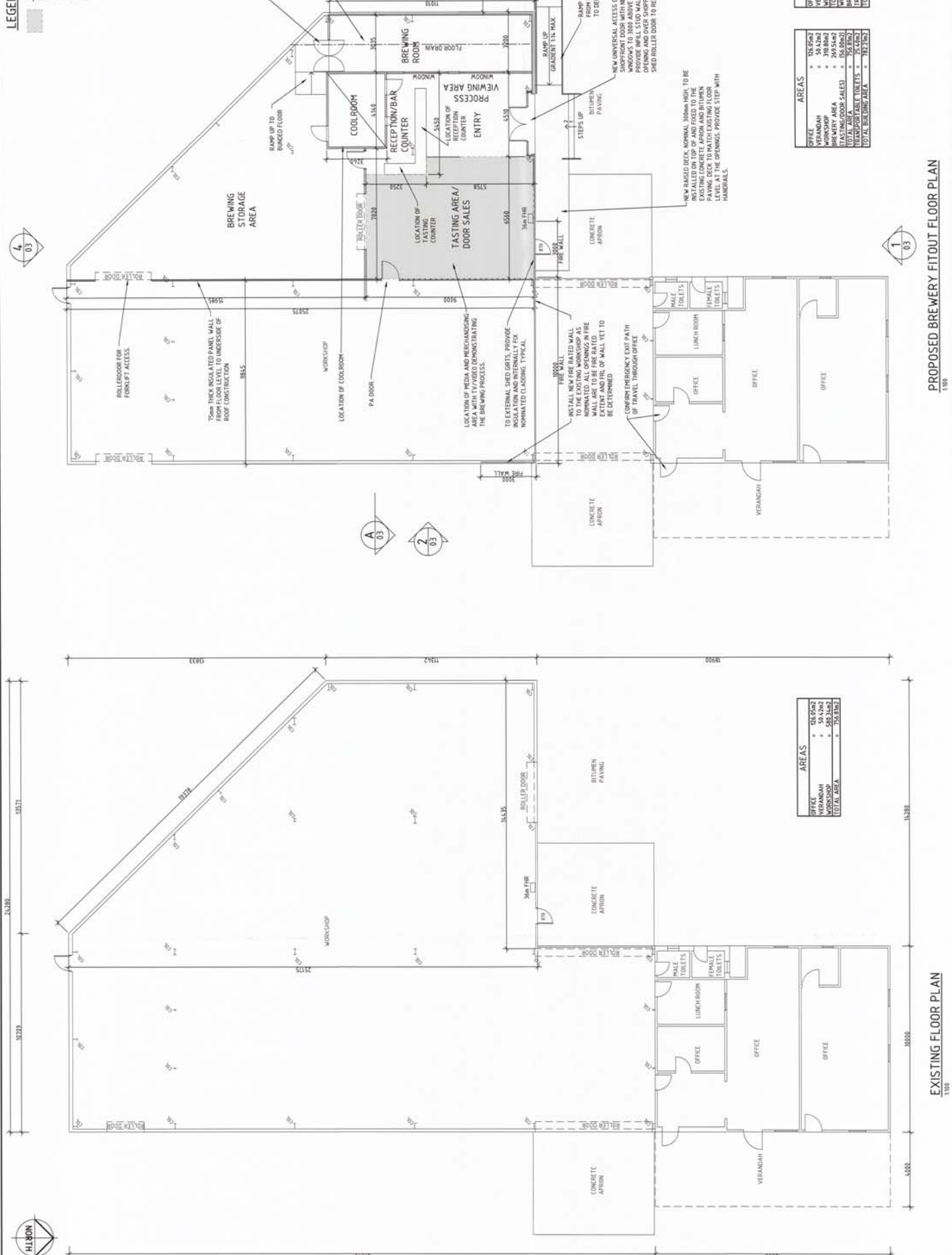

AREAS

OFFICE	=	106.69sq2
VERANDAH	=	55.42sq2
WORKSHOP	=	540.34sq2
TOTAL AREA	=	702.45sq2
WORKSHOP	=	540.34sq2
BREWERY AREA	=	205.54sq2
TOTAL AREA	=	745.88sq2
TOILET AREA	=	182.21sq2

FIRE COMPARTMENTS

OFFICE	=	106.69sq2
VERANDAH	=	55.42sq2
WORKSHOP	=	540.34sq2
TOTAL AREA	=	702.45sq2
WORKSHOP	=	540.34sq2
BREWERY AREA	=	205.54sq2
TOTAL AREA	=	745.88sq2
TOILET AREA	=	182.21sq2

EXISTING FLOOR PLAN
1:100

PROPOSED BREWERY FITOUT FLOOR PLAN
1:100

DESIGN	CLIENT	JUNE 2018	JUNE 2018
DRAWN	P.K.	JUNE 2018	JUNE 2018
DESIGNER	ENGINEER	ISSUED	
ISSUED			
DATE	DESCRIPTION		
REV	BY	DATE	DESCRIPTION
A	PK	21/06/18	ISSUE FOR REVIEW
B	PK	08/08/18	REVISE AND RE-ISSUE FOR REVIEW
C	PK	31/09/18	DEVELOP DRAWINGS AND RE-ISSUE FOR REVIEW
D	PK	01/07/18	REVISE AND RE-ISSUE FOR PLANNING REVIEW
E	PK	24/09/18	ISSUE FOR COPV PLANNING
F	PK	25/09/18	INCLUDE VERGE PARKING, RE-ISSUE FOR COPV PLANNING

L.E. ROBERTS BUILDING DESIGN
 ARCHITECTURAL DESIGN CONSULTANTS

NORTHWEST BREWING
PROPOSED CRAFT BREWERY
 LOT 100 MOOLGUNN ROAD, KARRATHA LIA
 FLOOR PLANS

SCALE: 1:100 (A1)

CONTRACTOR: M. GREY, ALL INFORMATION SUBJECT TO CONFIRMATION
 HANDS ON TO: BREWERY SCALE

APP: 10/01/18
 REV: 01 OF 03



NOTES

1. PAVING
 - 1.1 ALL EXISTING PAVING TO REMAIN
 - 1.2 NEW EMPLOYEE CRUSHED AGGREGATE TO VERGE PARKING AREA TO CITY OF KARRATHA TYPE 3rd PAVEMENT CONSTRUCTION SPECIFICATIONS.
2. CARPARKING
 - 2.1 EXISTING SITE PARKING TO REMAIN
 - 2.2 VERGE 45° VEHICLE CARPARKING BAYS TO AS 2895.1.1 TYPICAL

LEGEND

- VERGE CARPARK SURFACE
- COMPACTED CRUSHED AGGREGATE

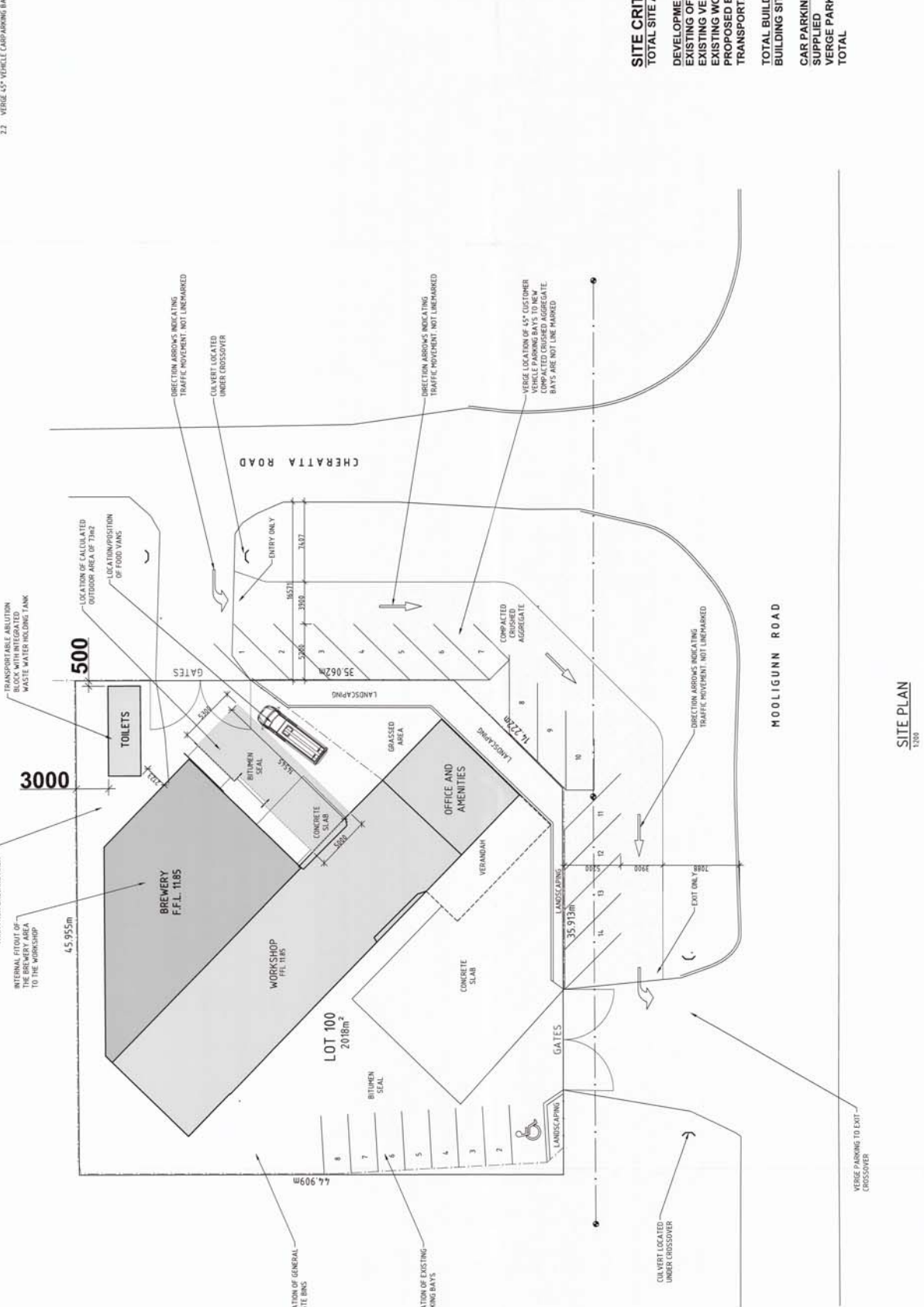

SITE CRITERIA - LOT 2572
TOTAL SITE AREA 2018m²

DEVELOPMENT AREAS	126.06m ²
EXISTING OFFICE	60.42m ²
EXISTING VERANDAH	310.80m ²
EXISTING WORKSHOP	289.54m ²
PROPOSED BREWERY	25.20m ²
TRANSPORTABLE TOILETS	782.21m ²
TOTAL BUILDING SITE AREA	782.21m ²
BUILDING SITE COVER	39%
CAR PARKING SUPPLIED	8
VERGE PARKING	14
TOTAL	22

SITE PLAN
1:200

<p>L.E. ROBERTS BUILDING DESIGN ARCHITECTURAL DESIGN CONSULTANTS</p>	
<p>ER</p>	<p>SCALE: 1:200 (A1) DRAWING No: 783-04-01 SHEET 31 OF 35</p>
<p>DESIGN DATE: JUNE 2016 CHECKED: L.R. ENGINEER: —</p>	<p>CLIENT: NORTHWEST BREWING PROJECT: PROPOSED CRAFT BREWERY LOT 100 MOOLIGUNN ROAD, KARRATHA LIA SITE PLAN</p>
<p>ISSUED</p>	<p>CONNECTION TO CHECK ALL DIMENSIONS PRIOR TO COMMENCEMENT WORKING TO QUOTE SCALE</p>
<p>REV: BY: DATE DESCRIPTION</p>	<p>END: APP</p>